

Classique III Non-Refrigerated Full Service Merchandiser 4', 5' & 6-1/2' L



NOTE: All temperature controlled cases are designed to operate in an environment of 75°F ambient temperature and 55% humidity level. Rear of unit needs to be 6" from a wall or obstruction.

Product specifications and design are subject to change without notice. Such changes do not entitle the buyer to corresponding changes, improvements, additions or replacement for equipment previously sold or shipped.

MODEL NUMBER	DIMENSIONS (L x D x H)
C3NB/WDFS48-01	49-1/2" x 38-7/8" x 49-3/8"
C3NB/WDFS59-01	60-1/2" x 38-7/8" x 49-3/8"
C3NB/WDFS77-01	78-1/2" x 38-7/8" x 49-3/8"

Classique III Non-Refrigerated Full Service Merchandiser 4', 5' & 6-1/2' L

STANDARD FEATURES

Case Interior

- Four levels of merchandising including three lighted shelves and one lighted display deck
- Stainless shelf brackets
- Rear sliding mirrored Pike doors
- 72" high front lift tempered glass
- Removable deck pans for easy cleaning
- Shelves are adjustable vertically in 1" increments and can also be angled at 15°

Lighting

- T-8 lighting
- Energy efficient T-8 ballast
- Top light and three (3) electrical shelves wired to an electrical ballast

Construction

- McCue bumper
- Sheet metal base construction
- Powder coated sheet metal back
- Insulated foamed tub
- Adjustable, floating stainless steel toe kick provides for easy sealing to an unlevelled floor

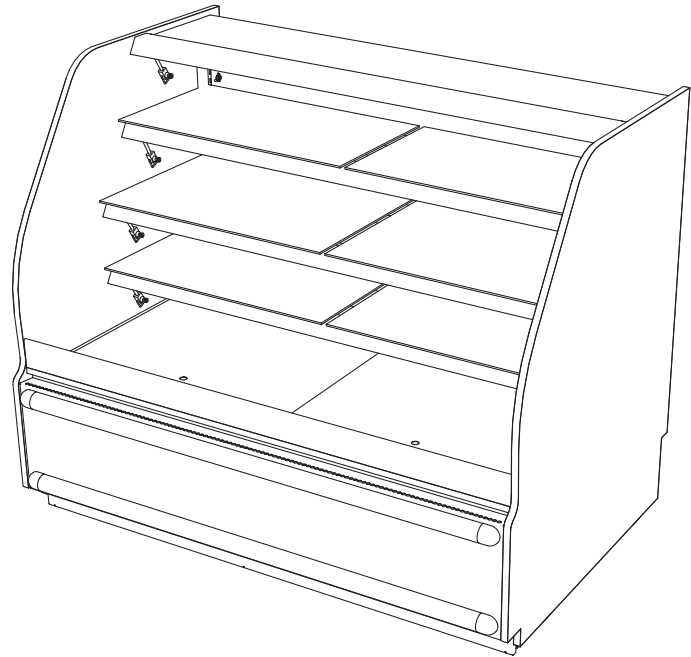

NOTE: All temperature controlled cases are designed to operate in an environment of 75°F ambient temperature and 55% humidity level. Rear of unit needs to be 6" from a wall or obstruction.

Product specifications and design are subject to change without notice. Such changes do not entitle the buyer to corresponding changes, improvements, additions or replacement for equipment previously sold or shipped.

MODEL NUMBER	DIMENSIONS (L x D x H)
C3NB/WDFS48-01	49-1/2" x 38-7/8" x 49-3/8"
C3NB/WDFS59-01	60-1/2" x 38-7/8" x 49-3/8"
C3NB/WDFS77-01	78-1/2" x 38-7/8" x 49-3/8"

Classique III Non-Refrigerated Full Service Merchandiser 4', 5' & 6-1/2' L

FRONT VIEW

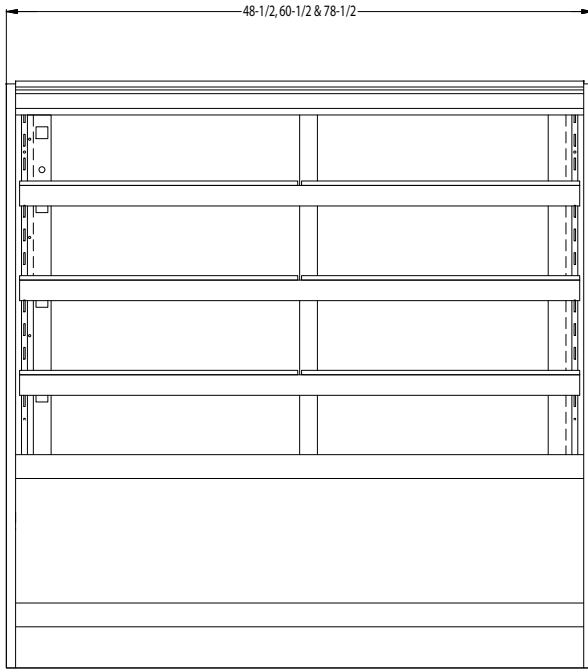

SIDE VIEW

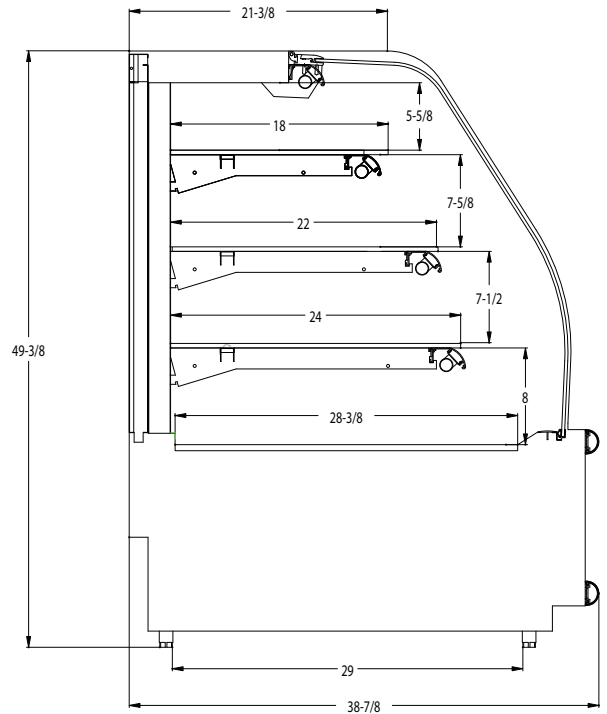

PRODUCT SPECIFICATION	STANDARD	OPTION(S)
Interior Color	Black or White	Powder coated brass light shields
Shelving	Tempered Clear Glass	Black or White Wire Racks
Lower Front Panel Color	Black or White	WilsonArt Standard and Custom Laminates
End Panel Color	Black or White, Mirrored interior	WilsonArt Standard and Custom Laminates
Rear Doors	Mirror	See thru mirror
Base Frame	Levelers	Casting, locking
McCue Bumper - 1" & 3"	Black	Other McCue Colors
Power Cord	Hardwired	NEMA plug

NOTE: All temperature controlled cases are designed to operate in an environment of 75°F ambient temperature and 55% humidity level. Rear of unit needs to be 6" from a wall or obstruction.

Product specifications and design are subject to change without notice. Such changes do not entitle the buyer to corresponding changes, improvements, additions or replacement for equipment previously sold or shipped.

MODEL NUMBER	DIMENSIONS (L x D x H)
C3NB/WDFS48-01	49-1/2" x 38-7/8" x 49-3/8"
C3NB/WDFS59-01	60-1/2" x 38-7/8" x 49-3/8"
C3NB/WDFS77-01	78-1/2" x 38-7/8" x 49-3/8"

Classique III Non-Refrigerated Full Service Merchandiser 4', 5' & 6-1/2' L

FOOTPRINT

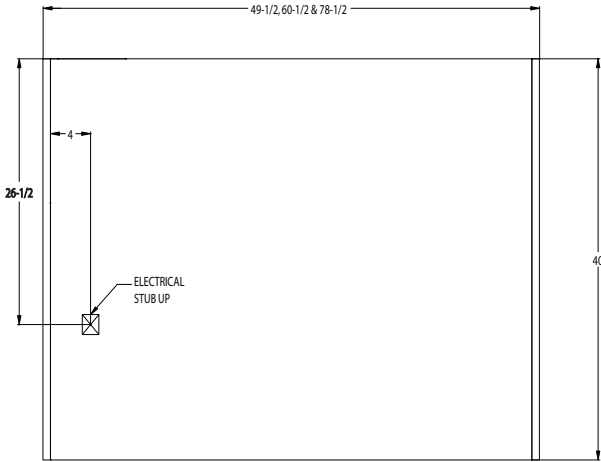

CERTIFICATIONS:

NOTE: CSC Worldwide products are certified to conform to NSF standards #2, #4, or #7, and UL standards #65, #197 or #471 through one or more of the following agencies: UL, NSF, ETL. Contact CSC Worldwide for verification or requests for certification.



MODEL	LENGTH	ELECTRICAL INFORMATION			FREIGHT	
		VOLTS	AMPS	NEMA PLUG	SHIP WT.	FRT. CLS.
C3NB/WDFS48-01	49-1/2"	115	.6	5-15P	500	92.5
C3NB/WDFS59-01	60-1/2"	115	.85	5-15P	650	92.5
C3NB/WDFS77-01	78-1/2"	115	1.8	5-15P	750	92.5

NOTE: All temperature controlled cases are designed to operate in an environment of 75°F ambient temperature and 55% humidity level. Rear of unit needs to be 6" from a wall or obstruction.

Product specifications and design are subject to change without notice. Such changes do not entitle the buyer to corresponding changes, improvements, additions or replacement for equipment previously sold or shipped.

MODEL NUMBER	DIMENSIONS (L x D x H)
C3NB/WDFS48-01	49-1/2" x 38-7/8" x 49-3/8"
C3NB/WDFS59-01	60-1/2" x 38-7/8" x 49-3/8"
C3NB/WDFS77-01	78-1/2" x 38-7/8" x 49-3/8"